

PROFESSIONAL EQUIPMENT

Gaither Bead Booster® (2" GB-38L)

Replacement Parts list

Ref. No.	Part No.	Description
1.	12910 BA	Aluminum Air Tank w/Piston Valve Inside
2.	12913 B2J ~	2 Inch Jet Assisted Barrel
3.	12912 B2 ~	(50.8 mm) 2" Lock Nut
4.	12927 B2 ~	Wide Plastic Protector
5.	12917 B ~	Safety Valve Max 10Bar
6.	12914 B	Pressure Gauge 10Bar
7.	12929 BA -	Rubber Pads w/1 screw
8.	12919 B -	Switch Valve
9.	12919 BS -	Safety Trigger Caps
10.	12928 BA -	3/4"PT x 1/4"PT Male Connector
11.	12915 ~	90 Degree NPT
12.	12916 GA ~	(6.35 mm) 1/4"PT Intake valve
13.	12927 ~	(6.35 mm) 1/4"PT Universal connector

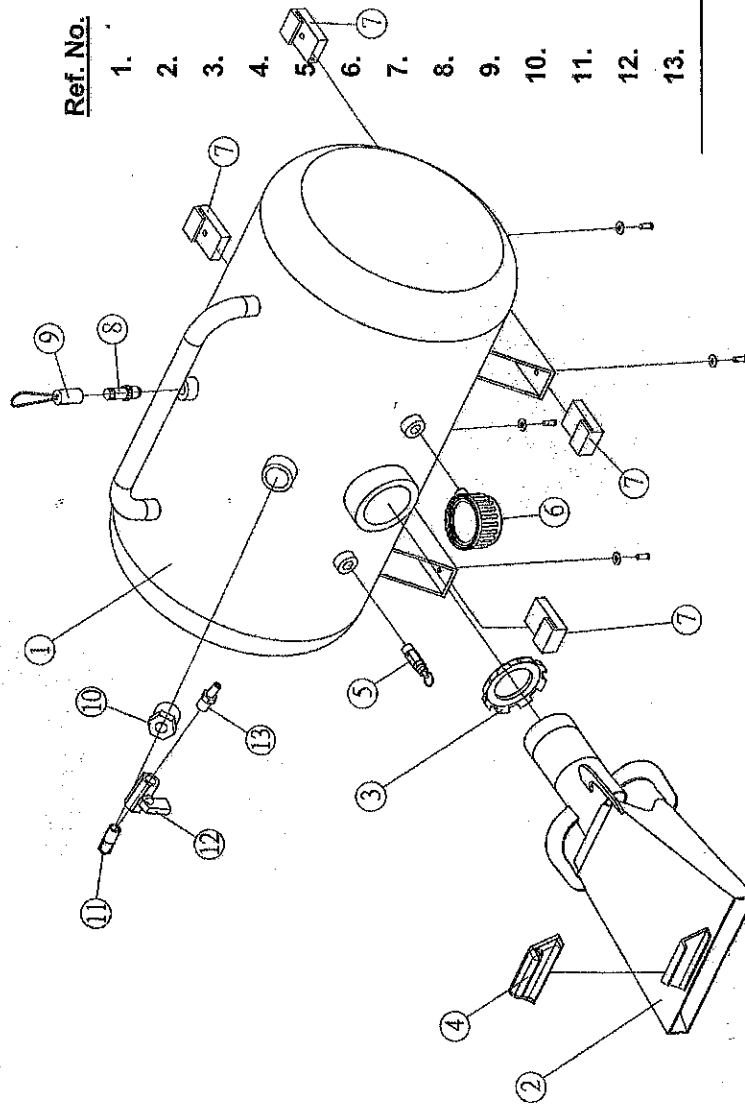

Bead Booster Accessories

14.	GB-51	KD-Tire Stand
15.	GB-52	Air-Whip Hose
16.	GB-53	Tire Wedge
17.	GB-54	Safety Pack (goggles & ear plugs)

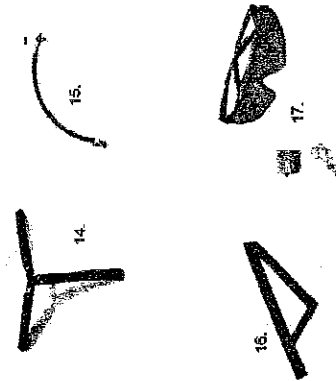

Gaither recommends this Bead Booster® tank be replaced after 3 years.

CAUTION Aluminum

Maximum pressure 116 PSI. Recommended operating pressure 60-116 PSI. Overfilling may result in death or serious injury. Fill this tank only from a service station or similar low pressure-116 PSI air compressor. Only replace filler valve, air hose, gauge with manufacturer recommended part or like fitting. Deflate tank before removing fitting. Discharge tank when not in use. Wear safety glasses and ear plugs. Do not remove or deface this label.